

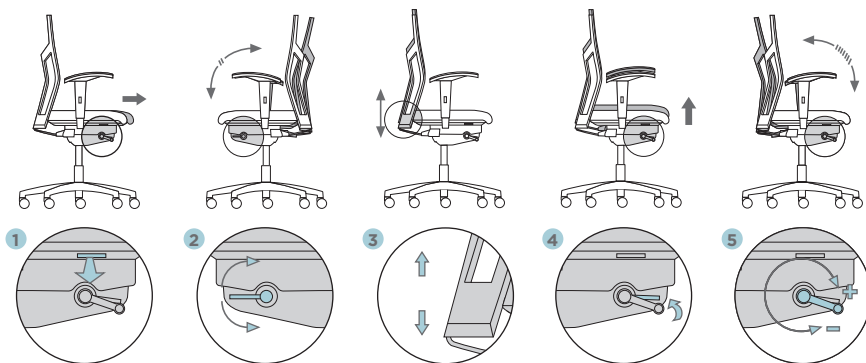

ZAS WORK CHAIR



FEATURES



Headrest height adjustment (optional)

Lumbar height adjustment

Seat depth adjustment

Pressure control

Seat height

2 models of armrest

Backrest lock

3 types of castors

NE polyamide base.
Painted or polished aluminum.



OPTIONS

Armrest

- Height adjustable (1D 2D: 80 mm, 5 positions)
- Rotation arm support (2D: 3 positions -15°, 0°, +15°)
- Width adjustable in assembling (50 mm, 25 each side)

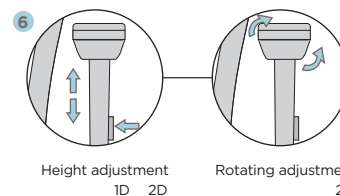

DIMENSIONS

1 • Backrest with headrest

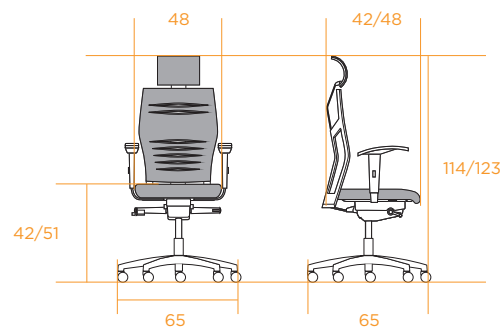

2 • Backrest without headrest

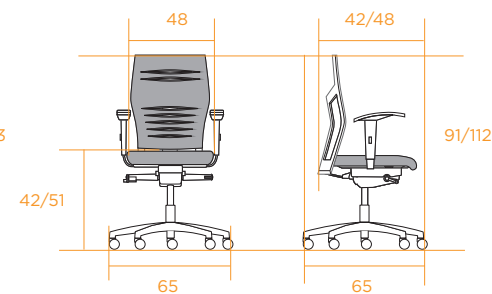

		• 1 •	• 2 •
kg	Weight in kg	19,5	18,00
d	Dimensions	70x70x120	70x70x120
Ta	Seat fabric	0,75+0,15	0,45
Tr	Backrest fabric	0,70	0,60
Pa	Seat leather	0,93	0,93
Pr	Backrest leather	0,93	0,93



ZAS WORK CHAIR

TECHNICAL SHEETS



DESCRIPTION

BACKREST

Height adjustable 60 mm with 5 positions (zipper regulation). Reclining angle up to 21°.

Option headrest 50 mm height adjustable with 5 positions, and 36° rotation with 4 positions.

An injected L-2630 aluminium structure with a mesh which allows a correct support and adaptation of the backrest to the anatomy of the user's back or with a polypropylene piece, highly resistant and flexible onto which the fabric is optionally fitted.

SEAT

Adjustable in depth 60 mm with 5 positions with a return spring to its original position.

Injection polypropylene support with ergonomically shaped flexible rubber foam with a 50 mm thickness and a density of 42 kg/m³, onto which the fabric is fitted.

MECHANISM

Spring-action synchro mechanism.

It can be locked in 4 position or permanent contact with non-return system. Pressure set by a lever to customise the pressure of the backrest.

BASE

Polyamide with fiber: Ø 680 mm, black finish.

Aluminum: Ø 700 mm, polished or painted epoxy polyester.

Soft and hard floor castors Ø 60, black color.

Option conductive castor Ø 60.



AMREST

In aluminium with a polyamide cover. Arm support in texturized polypropilene, soft touch.



▲ Z AMREST



▲ K AMREST



RECYCLABILITY RATE



CERTIFICATIONS AND STANDARDS

